

Progetto per realizzazione di nuova recinzione
e cancelli sul lato orientale Fondi Cossar

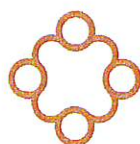

FONDAZIONE **AQUILEIA**

Il Committente :

<p><i>tavola</i></p> <p>2</p>	<p><i>oggetto</i></p> <p>DOCUMENTAZIONE FOTOGRAFICA</p>
<p><i>data</i></p>	
	<p>.....</p> <p>Progettista: arch. Ennio SNIDER</p> <p>viale Venezia 22 - Cervignano del Friuli (UD) www.studio4e.com - tel.0431/34665</p>

Estartto mappa catastale

C.C. Aquileia / A - f.m.4

6  numero fotografia e cono visivo

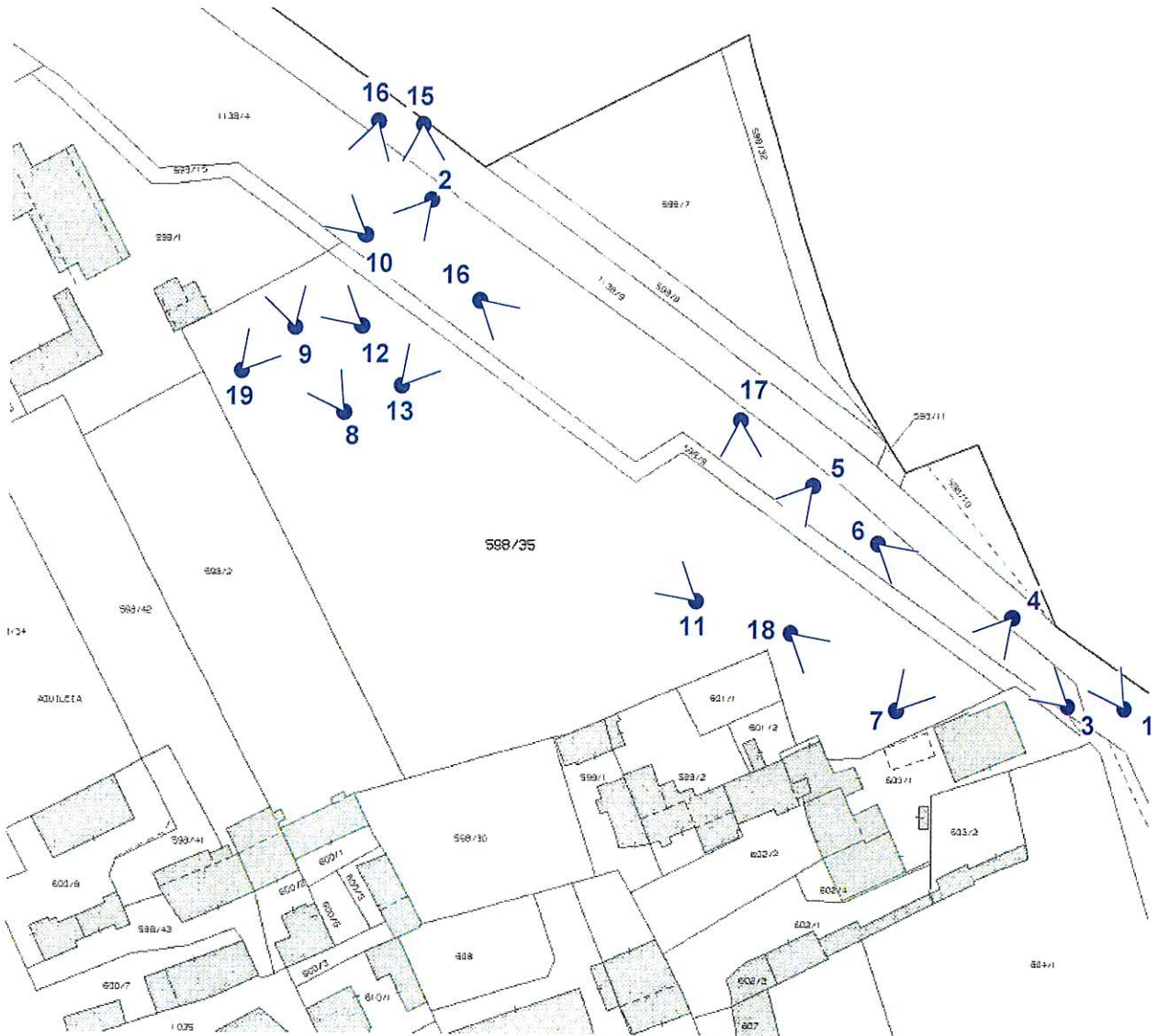



1



2



3



4



5



6



7

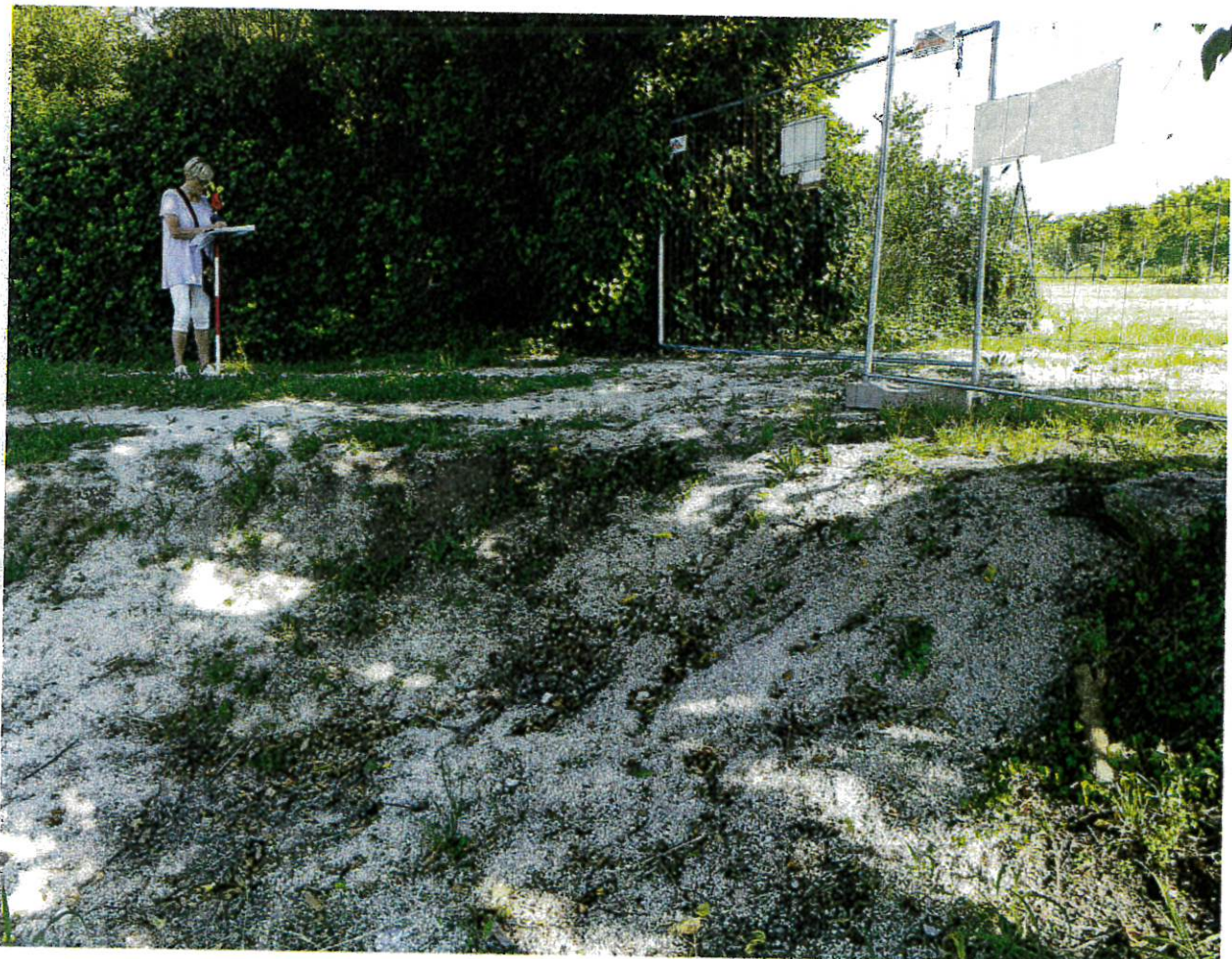

8



9



10



11



12



13



14



15

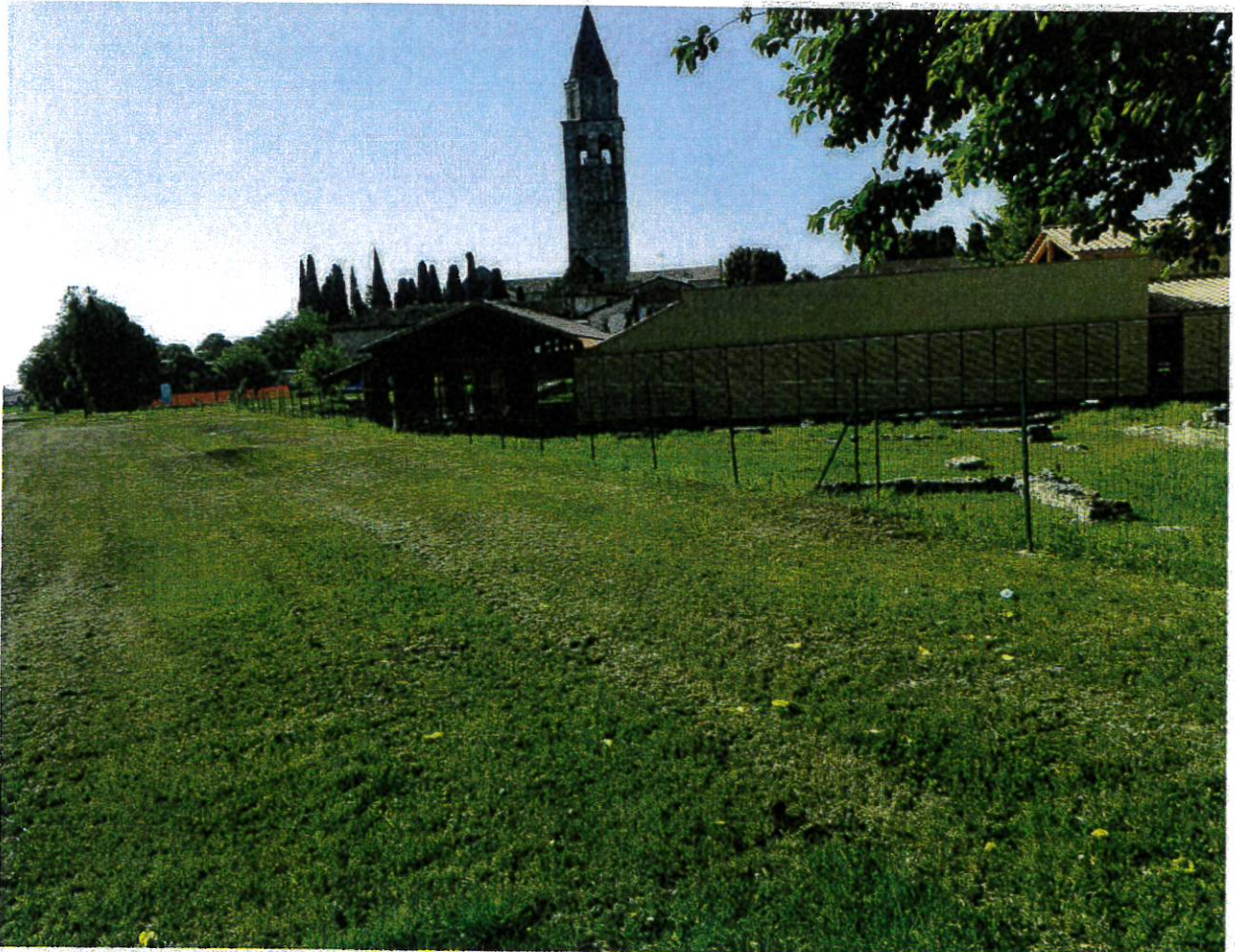

16

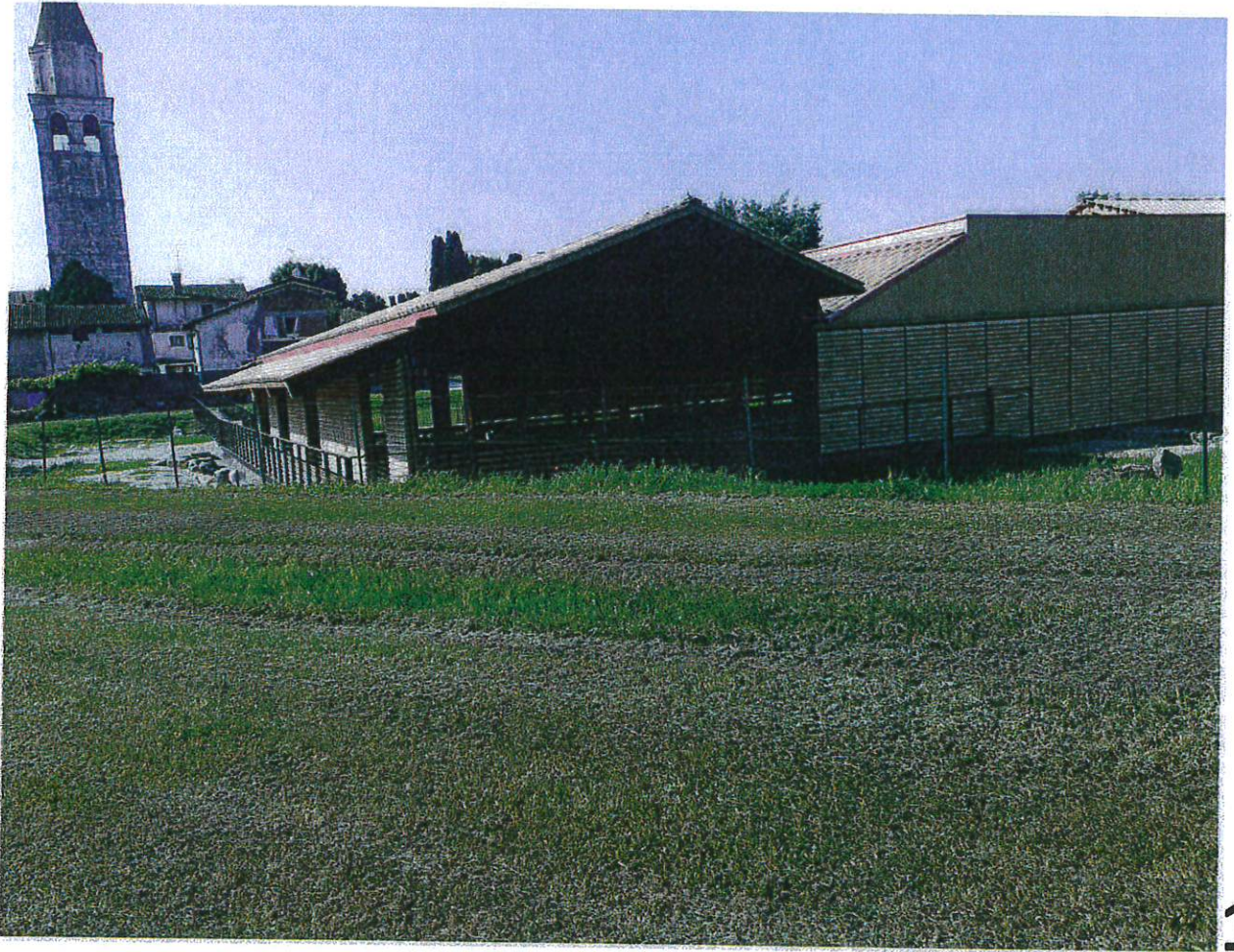

17



18



19